



## Premises Licence

**Premises Licence Number**  
**Date of Issue**

05/00672/LAPRE  
23rd August 2016

### Part 1 – Premises Details

Postal address of premises, or if none, ordnance survey map reference or description, including Post Town, Post Code

**East Tilbury Supermarket**  
**87/89 Coronation Avenue**  
**East Tilbury**  
**Essex**  
**RM18 8SW**

Telephone number

Where the licence is time limited the dates

Licensable activities authorised by the licence

**Sale by Retail of Alcohol**

Times the licence authorises the carrying out of licensable activities

**Sale by Retail of Alcohol**

<b>Monday</b>	<b>08:00 - 23:00</b>
<b>Tuesday</b>	<b>08:00 - 23:00</b>
<b>Wednesday</b>	<b>08:00 - 23:00</b>
<b>Thursday</b>	<b>08:00 - 23:00</b>
<b>Friday</b>	<b>08:00 - 23:00</b>
<b>Saturday</b>	<b>08:00 - 23:00</b>
<b>Sunday</b>	<b>10:00 - 22:30</b>
<b>Good Friday</b>	<b>08:00 - 22:30</b>
<b>Christmas Day</b>	<b>12:00 - 15:00 / 19:00 - 22:30</b>

The opening hours of the premises

<b>Monday</b>	<b>08:00 - 23:00</b>
<b>Tuesday</b>	<b>08:00 - 23:00</b>
<b>Wednesday</b>	<b>08:00 - 23:00</b>
<b>Thursday</b>	<b>08:00 - 23:00</b>
<b>Friday</b>	<b>08:00 - 23:00</b>
<b>Saturday</b>	<b>08:00 - 23:00</b>
<b>Sunday</b>	<b>10:00 - 22:30</b>

Where the licence authorises supplies of alcohol whether these are on and / or off supplies

**Alcohol is supplied for consumption off the Premises**

## Part 2

Name, (registered) address, telephone number and email (where relevant) of holder of premises licence

**Mr Tajinder Gurver**  
**Brick Lane**  
**Northolt**  
**UB5 6GS**

**07761266607**

**Tajinder Singh Khurana**  
**100 Rushdene Crescent**  
**Northolt**  
**UB5 6NH**

**07432139993**

Registered number of holder, for example company number, charity number (where applicable)

Name, address and telephone number of designated premises supervisor where the premises licence authorises for the supply of alcohol

**Mr Mustafa Er**

Personal licence number and issuing authority of personal licence held by designated premises supervisor where the premises licence authorises for the supply of alcohol

**Personal Licence Number: 126**  
**Licensing Authority: Thurrock Council**

## **Annex 1 – Mandatory conditions**

- 1** No supply of alcohol may be made under this licence
  - a)** At a time when there is no designated premises supervisor in respect of it or,
  - b)** At a time when the designated premises supervisor does not hold a personal licence or his personal licence is suspended.
  
- 2** Every supply of alcohol made under this licence must be made or authorised by a person who holds a personal licence.
  
- 3** (1) The premises licence holder or club premises certificate holder must ensure that an age verification policy is adopted in respect of the premises in relation to the sale or supply of alcohol.  
  
(2) The designated premises supervisor in relation to the premises licence must ensure that the supply of alcohol at the premises is carried on in accordance with the age verification policy.  
  
(3) The policy must require individuals who appear to the responsible person to be under 18 years of age (or such older age as may be specified in the policy) to produce on request, before being served alcohol, identification bearing their photograph, date of birth and either—
  - (a)** a holographic mark, or .
  - (b)** an ultraviolet feature.
  
- 4** (1). A relevant person shall ensure that no alcohol is sold or supplied for consumption on or off the premises for a price which is less than the permitted price.  
  
(2).For the purposes of the condition set out in paragraph 1 -
  - (a)** "duty" is to be construed in accordance with the Alcoholic Liquor Duties Act 1979;
  - (b)** "permitted price" is the price found by applying the formula where-  
  
$$P = D = (D \times V)$$
    - (i)** P is the permitted price,
    - (ii)** D is the amount of duty chargeable in relation to the alcohol as if the duty were charged on the date of the sale or supply of the alcohol, and
    - (iii)** V is the rate of value added tax chargeable in relation to the alcohol as if the value added tax were charged on the date of the sale or supply of the alcohol;
  - (c)** "relevant person" means, in relation to premises in respect of which there is in force a premises licence-
    - (i)** the holder of the premises licence,
    - (ii)** the designated premises supervisor (if any) in respect of such

a licence, or

(iii) the personal licence holder who makes or authorises a supply of alcohol under such a licence;

(d) "relevant person" means, in relation to premises in respect of which there is in force a club premises certificate, any member or officer of the club present on the premises in a capacity which enables the member or officer to prevent the supply in question; and

(e) "valued added tax" means value added tax charged in accordance with the Value Added Tax Act 1994.

(3) Where the permitted price given by Paragraph (b) of paragraph 3 would (apart from this paragraph) not be a whole number of pennies, the price given by that sub-paragraph shall be taken to be the price actually given by that sub-paragraph rounded up to the nearest penny.

(4) (1) Sub-paragraph (2) applies where the permitted price given by Paragraph (b) of paragraph 2 on a day ("the first day") would be different from the price permitted on the next day ("the second day") as a result of a change to the rate of duty or value added tax.

(2) The permitted price which would apply on the first day applies to sales and supplies of alcohol which take place before the expiry of the period of 14 days beginning on the second day.

## **Annex 2 – Conditions consistent with the Operating Schedule**

- 1 Log all refusals of the sale of alcohol in a register. This register to be made available to authorised officers.**
- 2 Alcohol shall not be sold in an open container or be consumed in the licensed premises.**

**Annex 3 – Conditions attached after a hearing by the licensing authority**



Annex 4 – Plans

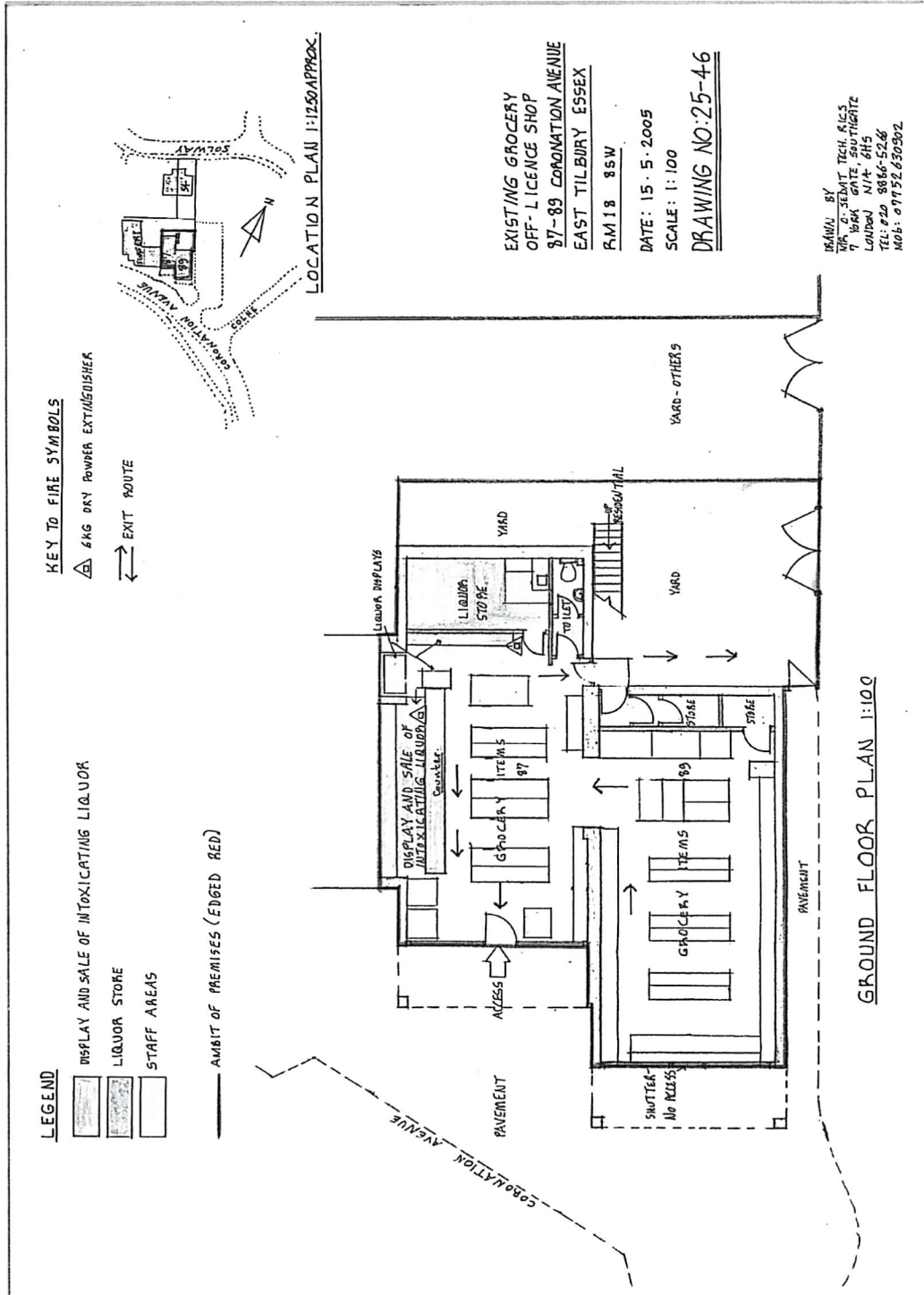

KEY TO FIRE SYMBOLS

▲ 4KG DRY POWDER EXTINGUISHER

⇌ EXIT ROUTE

LEGEND

▭ DISPLAY AND SALE OF INTERESTING LIQUORS

▭ LIQUOR STORE

▭ STAFF AREAS

— AMBIT OF PREMISES (EDGED RED)

GROUND FLOOR PLAN 1:100

LOCATION PLAN 1:1250 APPROX.

EXISTING GROCERY  
OFF-LICENCE SHOP  
37-89 CONORATION AVENUE  
EAST TILBURY ESSEX  
RM18 8SW  
DATE: 15.5.2005  
SCALE: 1:100  
DRAWING NO: 25-46

DRAWN BY  
MR. O. SEBASTIAN TECH. A.E.S.  
7 WARR GATE, SOUTHGATE  
LONDON N14 6HS  
TEL: 020 8866-5268  
MOB: 07752 630302





## Premises Licence Summary

**Premises Licence Number** 05/00672/LAPRE  
**Date of Issue** 23rd August 2016

### Part 1 – Premises Details

Postal address of premises, or if none, ordnance survey map reference or description, including Post Town, Post Code

**East Tilbury Supermarket**  
**87/89 Coronation Avenue**  
**East Tilbury**  
**Essex**  
**RM18 8SW**

Telephone number

Where the licence is time limited the dates

Licensable activities authorised by the licence

**Sale by Retail of Alcohol**

Times the licence authorises the carrying out of licensable activities

**Sale by Retail of Alcohol**

<b>Monday</b>	<b>08:00 - 23:00</b>
<b>Tuesday</b>	<b>08:00 - 23:00</b>
<b>Wednesday</b>	<b>08:00 - 23:00</b>
<b>Thursday</b>	<b>08:00 - 23:00</b>
<b>Friday</b>	<b>08:00 - 23:00</b>
<b>Saturday</b>	<b>08:00 - 23:00</b>
<b>Sunday</b>	<b>10:00 - 22:30</b>
<b>Good Friday</b>	<b>08:00 - 22:30</b>
<b>Christmas Day</b>	<b>12:00 - 15:00 / 19:00 - 22:30</b>

The opening hours of the premises

<b>Monday</b>	<b>08:00 - 23:00</b>
<b>Tuesday</b>	<b>08:00 - 23:00</b>
<b>Wednesday</b>	<b>08:00 - 23:00</b>
<b>Thursday</b>	<b>08:00 - 23:00</b>
<b>Friday</b>	<b>08:00 - 23:00</b>
<b>Saturday</b>	<b>08:00 - 23:00</b>
<b>Sunday</b>	<b>10:00 - 22:30</b>

Where the licence authorises supplies of alcohol whether these are on and / or off supplies

**Alcohol is supplied for consumption off the Premises**

## Part 2

Name, (registered) address, telephone number and email (where relevant) of holder of premises licence

**Mr Tajinder Gurver**  
**Brick Lane**  
**Northolt**  
**UB5 6GS**

**07761266607**

**Tajinder Singh Khurana**  
**100 Rushdene Crescent**  
**Northolt**  
**UB5 6NH**

**07432139993**

Registered number of holder, for example company number, charity number (where applicable)

Name of designated premises supervisor where the premises licence authorises for the supply of alcohol

**Mr Mustafa Er**

Personal licence number and issuing authority of personal licence held by designated premises supervisor where the premises licence authorises for the supply of alcohol

**Personal Licence Number: 126**  
**Licensing Authority: Thurrock Council**